

N(Y): 7.744.500,0000

N(Y): 7.743.500,0000

E(X): 283.300,0000

E(X): 284.300,0000

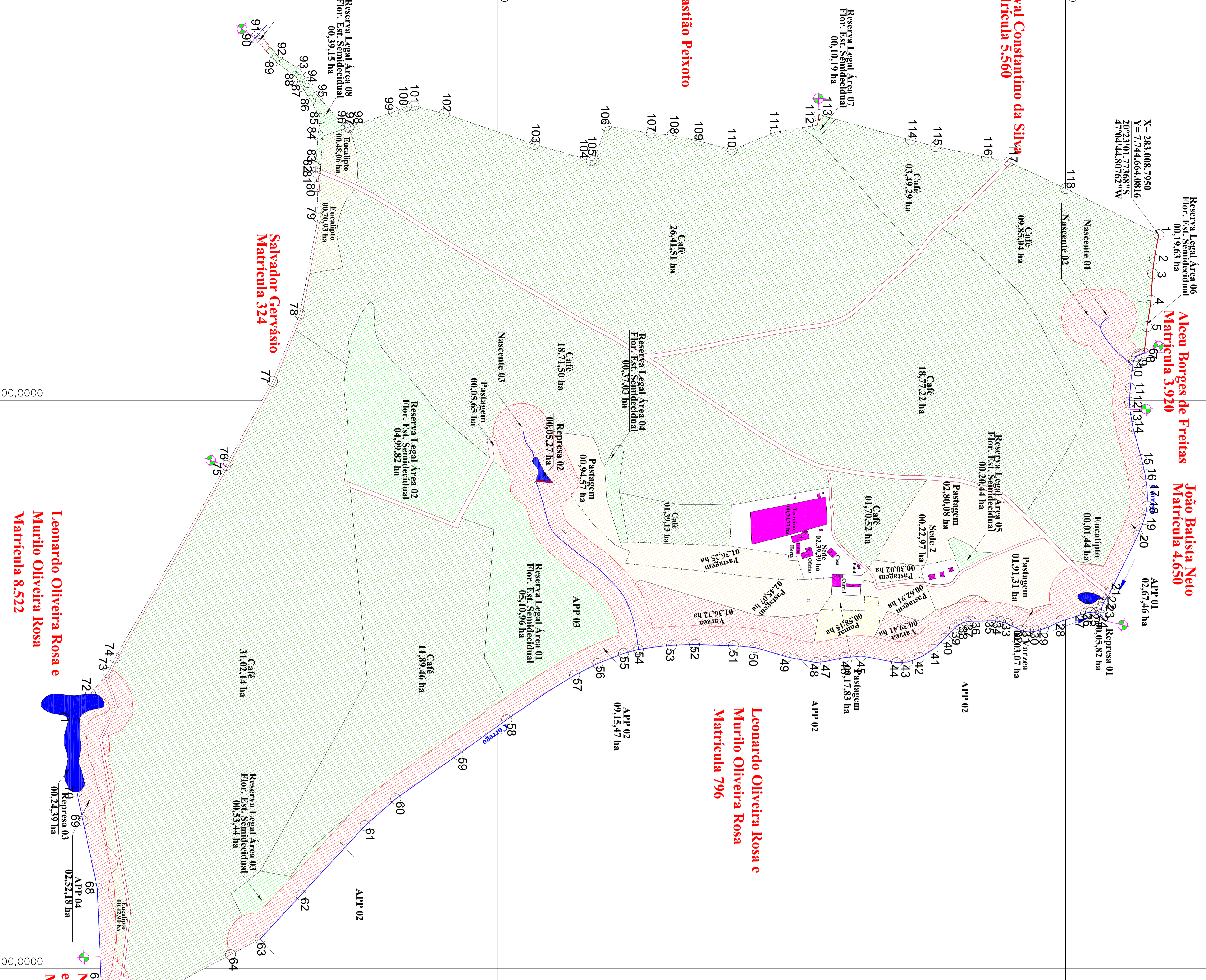

De	Para	Área Total	Coord. E (m)	Coord. N (m)
1	2	0,0799	283,051,673	7,744,629,288
2	3	9,0323	283,077,3162	7,744,653,160
3	4	9,0323	283,124,089	7,744,661,833
4	5	9,0323	283,170,853	7,744,664,308
5	6	16,0080	283,219,1175	7,744,651,1978
6	7	15,0403	283,222,4593	7,744,625,1044
7	8	12,0581	283,231,5671	7,744,618,9188
8	9	10,1353	283,238,4000	7,744,618,3511
9	10	9,6010	283,278,7597	7,744,614,1020
10	11	8,7140	283,305,4062	7,744,618,2834
11	12	7,9501	283,328,6722	7,744,626,983
12	13	7,0018	283,348,6414	7,744,634,1006
13	14	7,7005	283,306,6414	7,744,634,1006
14	15	6,7005	283,300,0784	7,744,639,9640
15	16	8,9210	283,288,0784	7,744,644,7214
16	17	9,0323	283,288,0784	7,744,644,7214
17	18	10,2034	283,288,0784	7,744,644,7214
18	19	11,3554	283,300,9425	7,744,638,2506
19	20	11,8710	283,337,5382	7,744,627,1261
20	21	12,2160	283,337,5382	7,744,578,3980
21	22	12,2160	283,337,5382	7,744,578,3980
22	23	10,8410	283,366,2011	7,744,566,6973
23	24	9,9840	283,366,2011	7,744,566,6973
24	25	20,6147	283,677,3298	7,744,561,8884
25	26	18,3518	283,677,3298	7,744,561,8884
26	27	16,2590	283,703,5182	7,744,558,3482
27	28	16,2590	283,703,5182	7,744,558,3482
28	29	15,7008	283,687,8866	7,744,492,4417
29	30	16,2590	283,703,5182	7,744,558,3482
30	31	17,1994	283,704,1563	7,744,447,2175
31	32	18,4848	283,704,1563	7,744,435,3427
32	33	20,6147	283,704,8215	7,744,421,3427
33	34	19,7907	283,695,0466	7,744,397,9365
34	35	18,6005	283,680,1730	7,744,385,6863
35	36	17,8639	283,680,1730	7,744,385,6863
36	37	17,4110	283,688,6621	7,744,372,8032
37	38	15,8715	283,688,6621	7,744,338,5332
38	39	15,8715	283,688,6621	7,744,338,5332
39	40	13,2456	283,700,5759	7,744,304,4788
40	41	13,2456	283,700,5759	7,744,304,4788
41	42	14,9144	283,728,1969	7,744,266,6322
42	43	15,9213	283,728,1969	7,744,243,2570
43	44	17,0035	283,752,6856	7,744,221,9395
44	45	19,0203	283,764,493	7,744,202,9763
45	46	17,4890	283,794,9472	7,744,140,0652
46	47	16,8230	283,752,6856	7,744,110,6149
47	48	17,4024	283,750,5171	7,744,077,0129
48	49	19,0512	283,750,5171	7,744,060,0088
49	50	19,0512	283,750,5171	7,744,060,0088
50	51	18,3098	283,752,6856	7,743,919,6090
51	52	17,7876	283,729,3870	7,743,843,7337
52	53	17,7876	283,729,3870	7,743,843,7337
53	54	17,2361	283,700,8292	7,743,806,4750
54	55	16,8175	283,728,1969	7,743,784,4789
55	56	15,8715	283,745,2103	7,743,722,5180
56	57	15,8715	283,745,2103	7,743,722,5180
57	58	14,8604	283,783,5811	7,743,626,3499
58	59	14,8604	283,861,9373	7,743,516,6480
59	60	14,8604	283,861,9373	7,743,516,6480
60	61	13,8438	283,923,4309	7,743,431,2976
61	62	13,8438	283,923,4309	7,743,431,2976
62	63	13,2456	284,048,4374	7,743,286,8112
63	64	12,2322	284,170,8160	7,743,188,4229
64	65	12,2322	284,170,8160	7,743,188,4229
65	66	15,2085	284,175,1507	7,743,030,9398
66	67	15,2085	284,175,1507	7,743,030,9398
67	68	16,7944	284,506,1064	7,742,802,5860
68	69	16,7944	284,506,1064	7,742,802,5860
69	70	26,7394	284,536,4218	7,742,808,5924
70	71	27,9630	284,536,4218	7,742,808,5924
71	72	27,9630	284,536,4218	7,742,808,5924
72	73	26,9329	284,328,3932	7,742,796,6421
73	74	26,9329	284,328,3932	7,742,796,6421
74	75	25,7846	284,180,6525	7,742,771,4475
75	76	25,7846	284,180,6525	7,742,771,4475
76	77	26,7394	284,040,1387	7,742,711,4475
77	78	26,7394	284,040,1387	7,742,711,4475
78	79	26,9329	283,889,0903	7,742,764,6065
79	80	26,9329	283,889,0903	7,742,764,6065
80	81	27,9630	283,853,2481	7,742,754,0975
81	82	27,9630	283,853,2481	7,742,754,0975
82	83	27,9630	283,853,2481	7,742,754,0975
83	84	27,9630	283,853,2481	7,742,754,0975
84	85	27,9630	283,853,2481	7,742,754,0975
85	86	24,1584	283,816,3819	7,742,784,5478
86	87	24,1584	283,816,3819	7,742,784,5478
87	88	23,6606	283,779,0684	7,742,854,4318
88	89	23,6606	283,779,0684	7,742,854,4318
89	90	23,6606	283,779,0684	7,742,854,4318
90	91	23,6606	283,779,0684	7,742,854,4318
91	92	23,6606	283,779,0684	7,742,854,4318
92	93	31,2223	282,694,1722	7,743,113,9409
93	94	31,2223	282,694,1722	7,743,113,9409
94	95	48,5138	282,741,1722	7,743,166,4909
95	96	48,5138	282,741,1722	7,743,166,4909
96	97	34,2028	282,821,2252	7,743,233,9722
97	98	34,2028	282,821,2252	7,743,233,9722
98	99	34,2028	282,821,2252	7,743,233,9722
99	100	34,2028	282,821,2252	7,743,233,9722
100	101	34,2028	282,821,2252	7,743,233,9722
101	102	16,8603	282,795,7822	7,743,407,2819
102	103	16,8603	282,795,7822	7,743,407,2819
103	104	16,8603	282,795,7822	7,743,407,2819
104	105	16,8603	282,795,7822	7,743,407,2819
105	106	28,9322	282,877,8856	7,743,670,1776
106	107	28,9322	282,877,8856	7,743,670,1776
107	108	9,9032	282,817,5966	7,743,691,6589
108	109	12,7148	282,830,1491	7,743,770,3088
109	110	12,7148	282,830,1491	7,743,770,3088
110	111	14,3915	282,844,1258	7,743,853,1076
111	112	14,3915	282,844,1258	7,743,853,1076
112	113	33,7307	282,859,4795	7,743,913,8302
113	114	33,7307	282,859,4795	7,743,913,8302
114	115	15,0044	282,979,4263	7,744,006,6420
115	116	15,0044	282,979,4263	7,744,006,6420
116	117	11,9412	282,853,8896	7,744,271,6273
117	118	11,9412	282,853,8896	7,744,271,6273
118	119	25,9031	282,880,7383	7,744,400,5095
119	120	25,9031	282,880,7383	7,744,400,5095
120	121	26,3230	282,927,6571	7,744,500,5112
121	122	26,3230	282,927,6571	7,744,500,5112

Área Total
169,9935 ha
169,9935 ha
70,2453 Alqs
6,413,569 m²

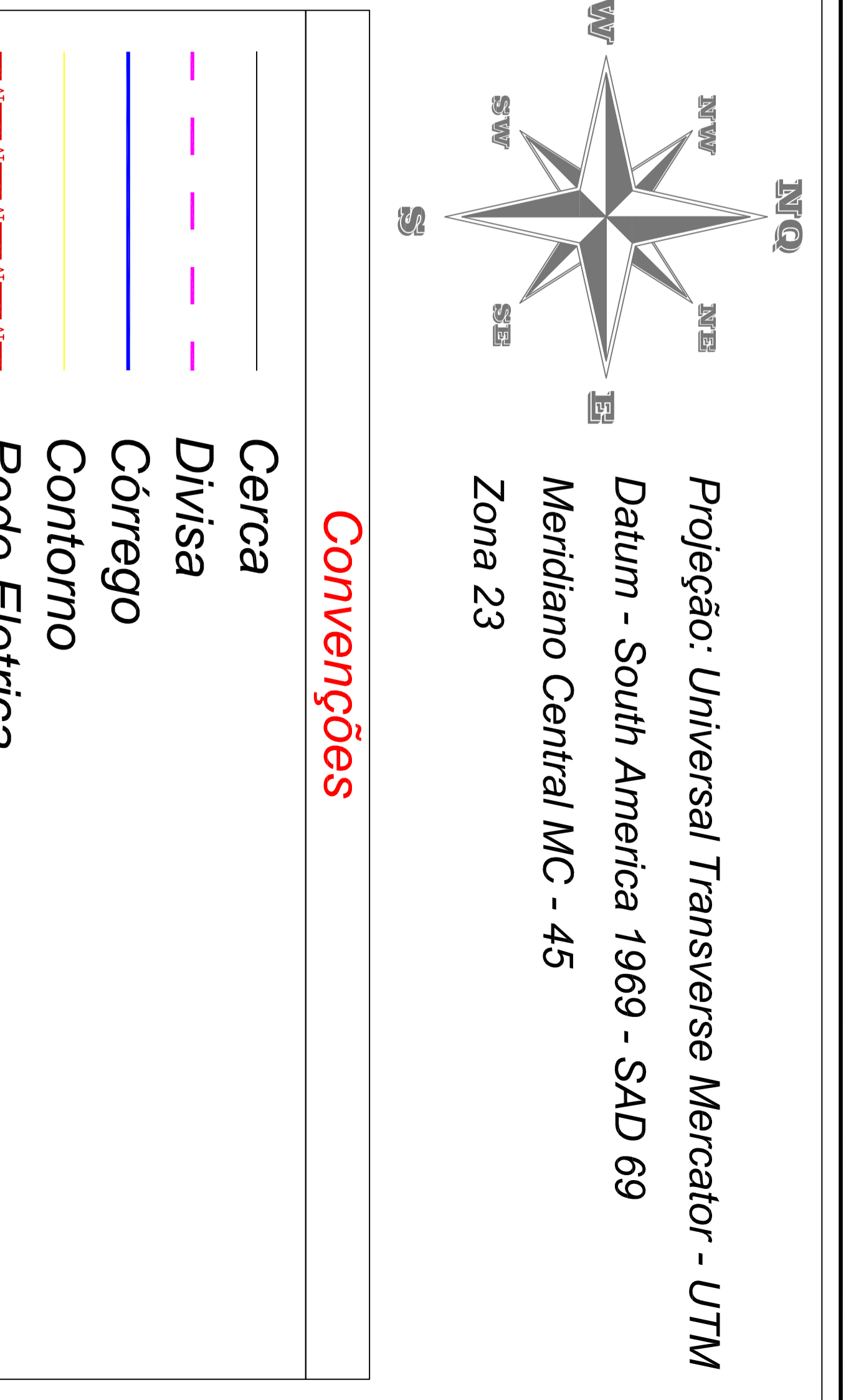

Convenções

	Cerca
	Divisa
	Corrego
	Contorno
	Ferrovia
	Rede Elétrica
	Grota
	Estrada
	Edificações
	Divisa Confrontante
	Altimetria - Curvas Mestras
	Altimetria - Curvas Auxiliares
	Rodovia

Quadro de Áreas

Descrição	Área (ha)	%
Café	123,25,81	72,51
Pastagem	10,63,69	06,26
Reserva Legal	11,90,66	07,00
Preservação Permanente	16,17,50	09,52
Eucalipto	01,63,33	00,96
Benfeitorias	02,64,13	01,55
Estradas	02,80,60	01,65
Represas	00,35,48	00,21
Pomar	00,58,15	00,34
Total	169,99,35	100,00

Av. João Alves do Nascimento, 2295/19 Centro
CEP: 38740-000 - Patrocinio - MG
Fone/Fax: (34) 3831-9844
Home Page: www.agrosolos.com.br
E-mail: agrosolos@agrosolos.com.br



FAZ. CAFFERRA S. JUDAS TADEU

Proprietário: José Marcos Chicaroni e Outros
Município: Ibiraci - MG
Área Lev.: 169,99,35 ha Matrícula: 813
Referência: Levantamento Cadastral
Data: 06/12/2010 Escala: 1:5.000
Responsável Técnico:

Salomão Santana Filho
Eng. Agrônomo M.Sc., D.S.
CREA - MG 79.656 / D

Levantamento Topográfico: Lader Ferreira de Menezes - CREA. 501.795/TD.
Desenhista: Rodrigo Teixeira Côrtes Oliveira